

# Design Detailing:

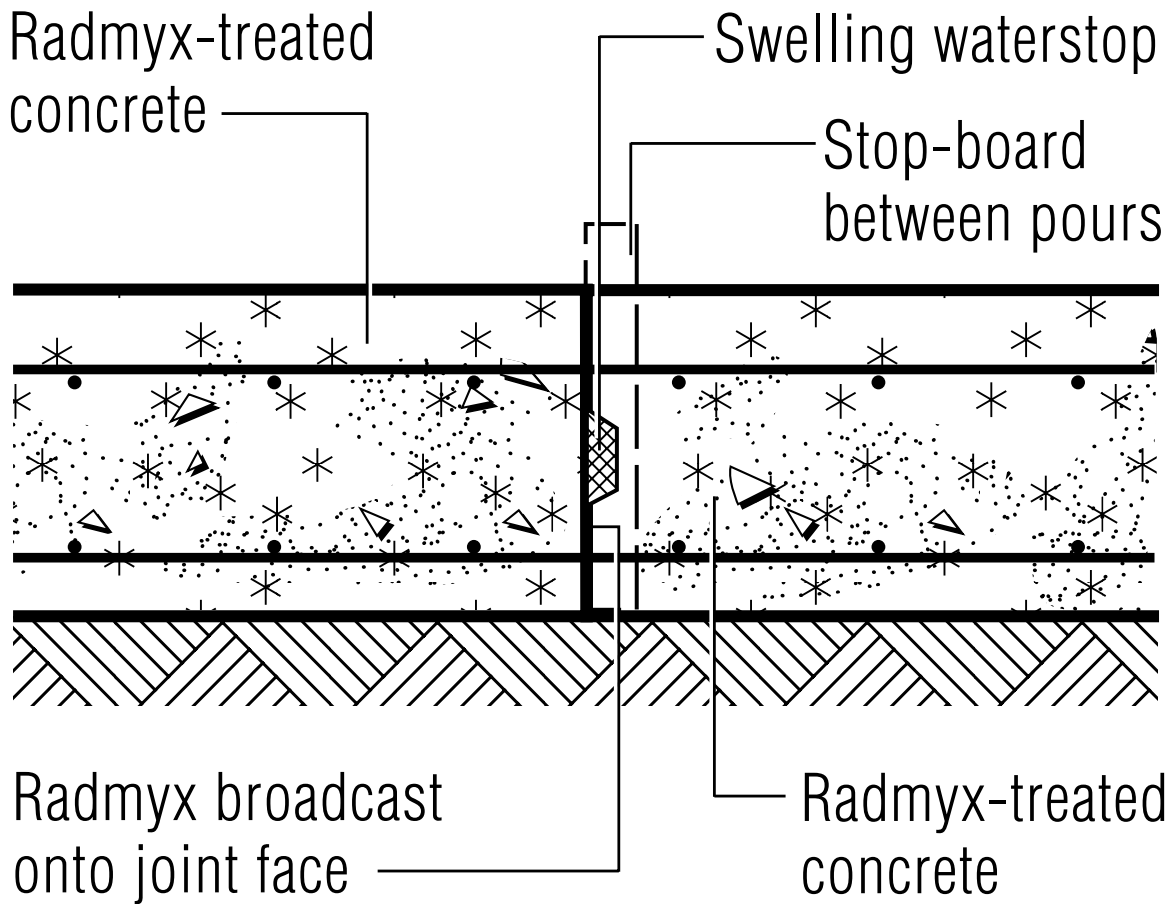

## Slab Cold Joint (Admixture)



## COLD JOINT DETAIL

### Instructions:

- 1) Use Stop board to finish Pour.
- 2) Trowel down area where waterstop is to be applied to smooth & flat.
- 3) Roughen joint either side to provide an adequate key.
- 4) Install swelling waterstop to manufactures instructions.
- 5) Broadcast Radmyx as a dry shake to joint at  $1\text{kg/m}^2$ .
- 6) Pour next slab.

## Floor to Wall Cold Joint (Admixture)

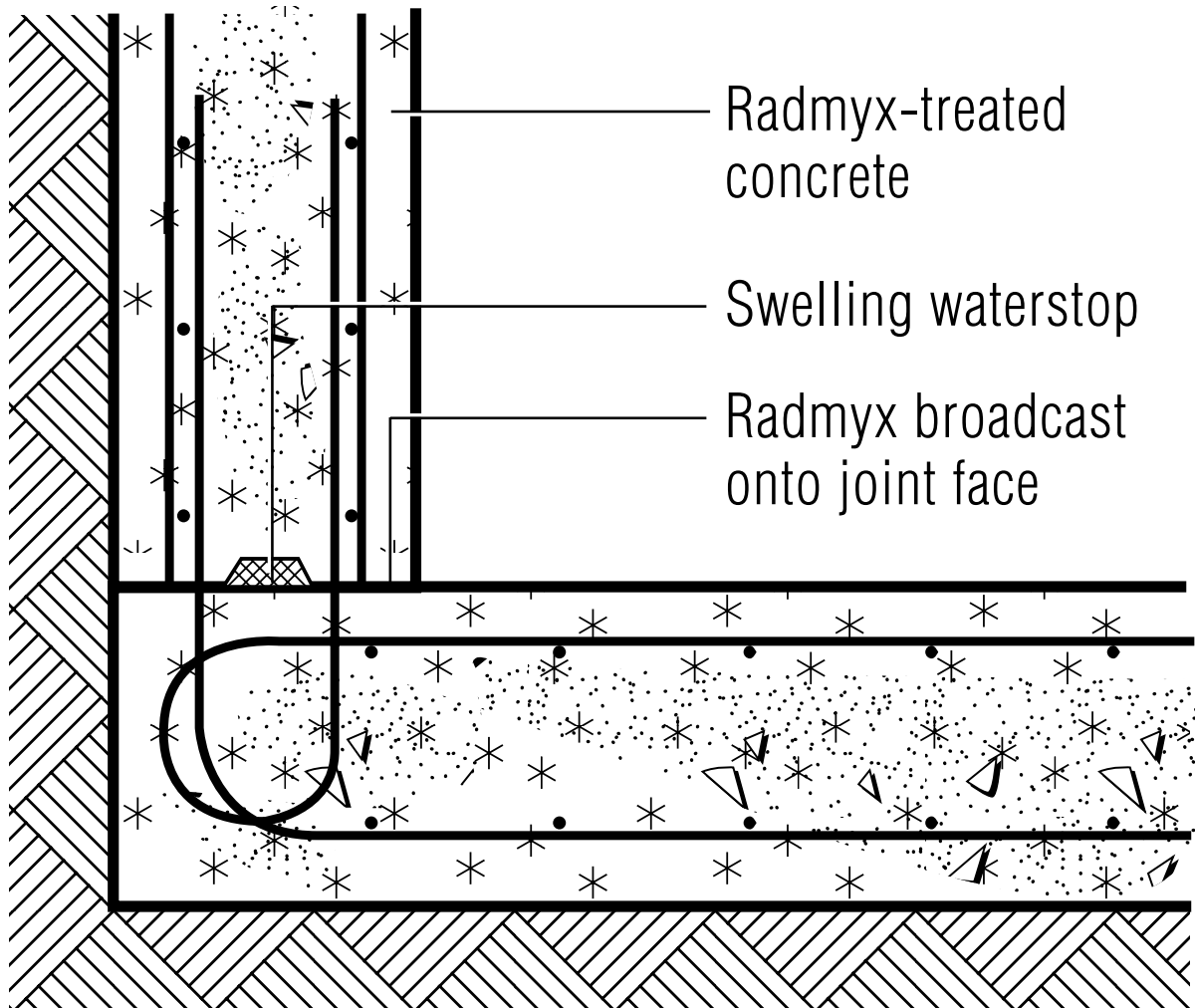

## WALL/FLOOR DETAIL

### Instructions:

- 1) Trowel down area where waterstop is to be applied to smooth & flat.
- 2) Roughen joint either side to provide an adequate key.
- 3) Install swelling waterstop to manufactures instructions.
- 4) Broadcast Radmyx as a dry shake to joint at  $1\text{kg/m}^2$ .
- 5) Pour wall.

# Design Detailing:



## Penetration (Admixture)

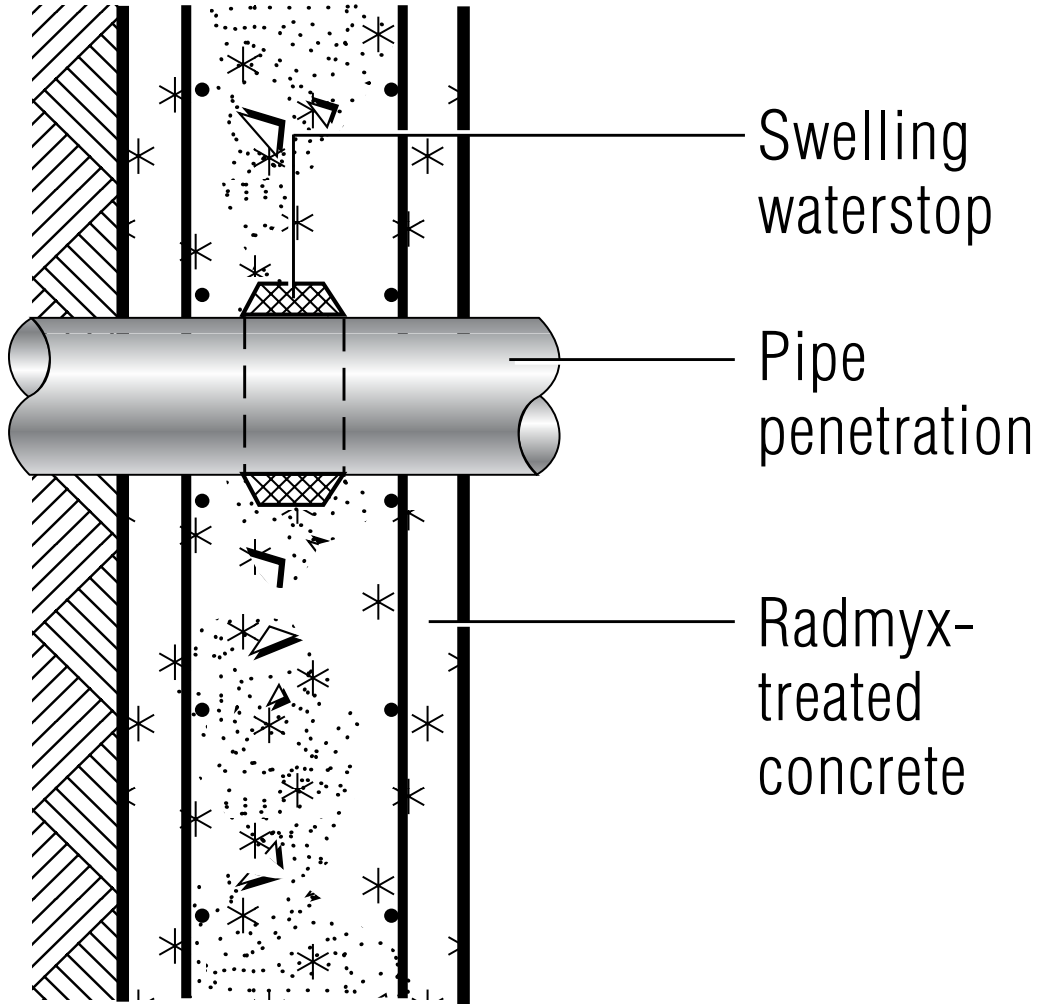

## PENETRATION DETAIL

### Instructions:

- 1) Use swelling waterstops around penetration according specification.
- 2) Pour Concrete with Radmyx Admixture.

## Floor Repair

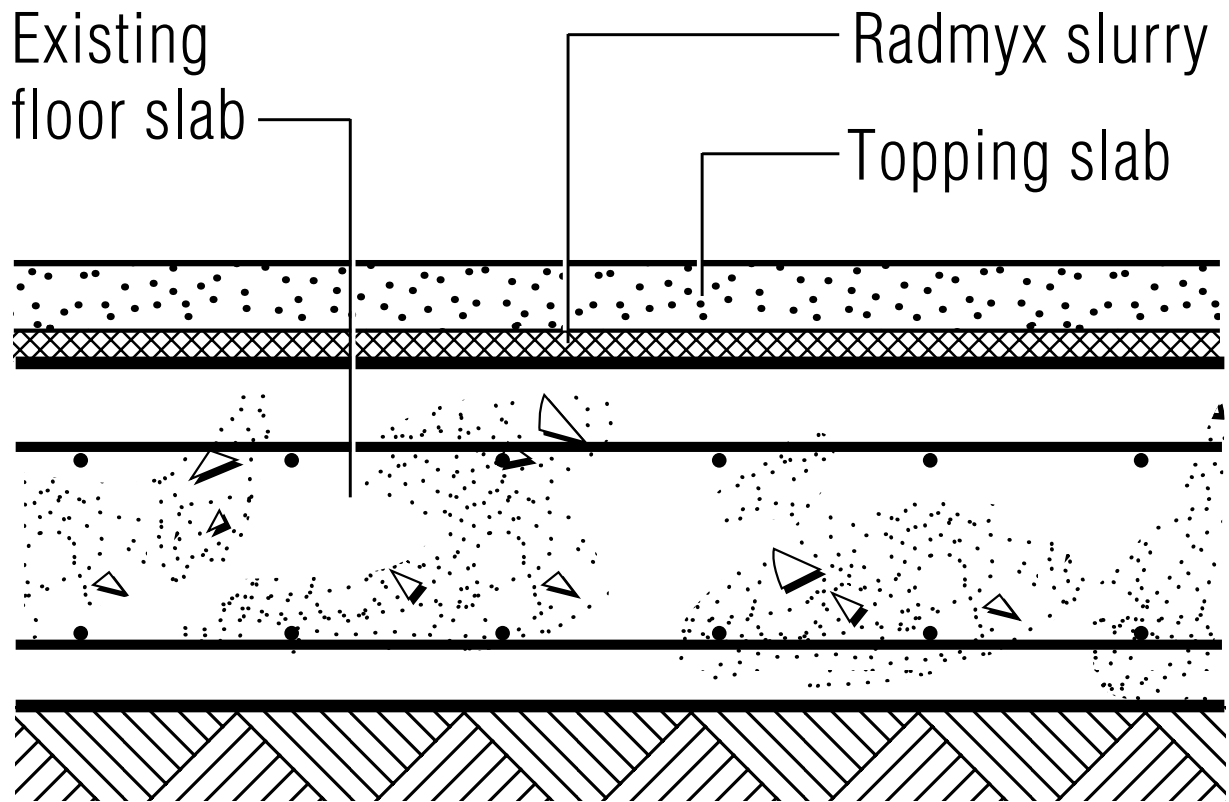

# FLOOR REPAIR

### Instructions:

- 1) Dampen Floor Area with water.
- 2) Apply Radmyx Slurry in 2 coats at 0.8kg / Sqm.
- 3) Pour Topping slab on floor.

# Design Detailing:



## Floor to Wall Cold Joint Repair

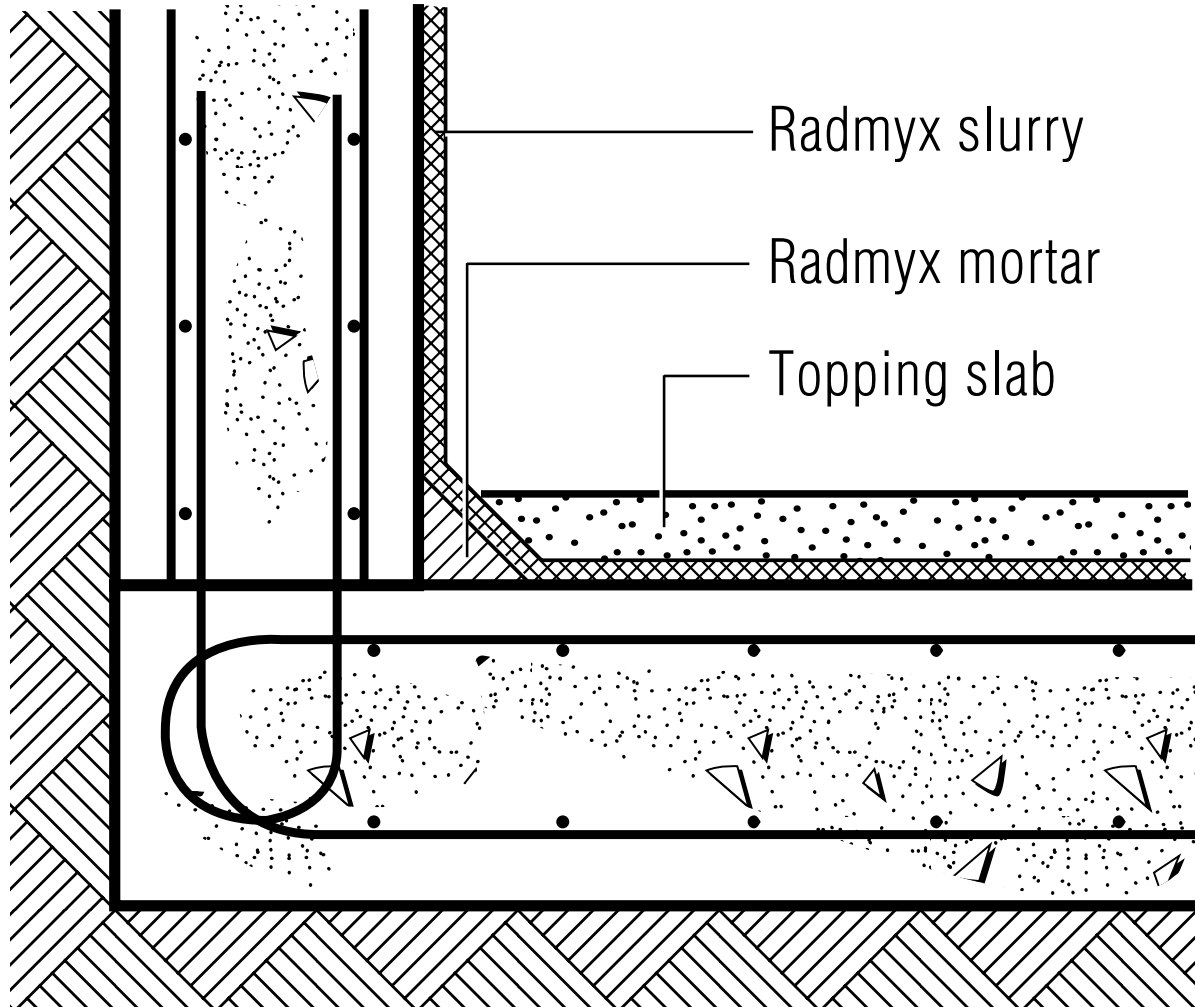

## WALL/FLOOR REPAIR

### Instructions:

- 1) Dampen Joint Area with water.
- 2) Create fillet in corner with Radmyx Mortar.
- 3) When firm – Dampen Wall/ Floor with Water.
- 4) Apply Radmyx Slurry in 2 coats at 0.8kg / Sqm.
- 5) Pour Topping slab on floor.

## Crack Repair

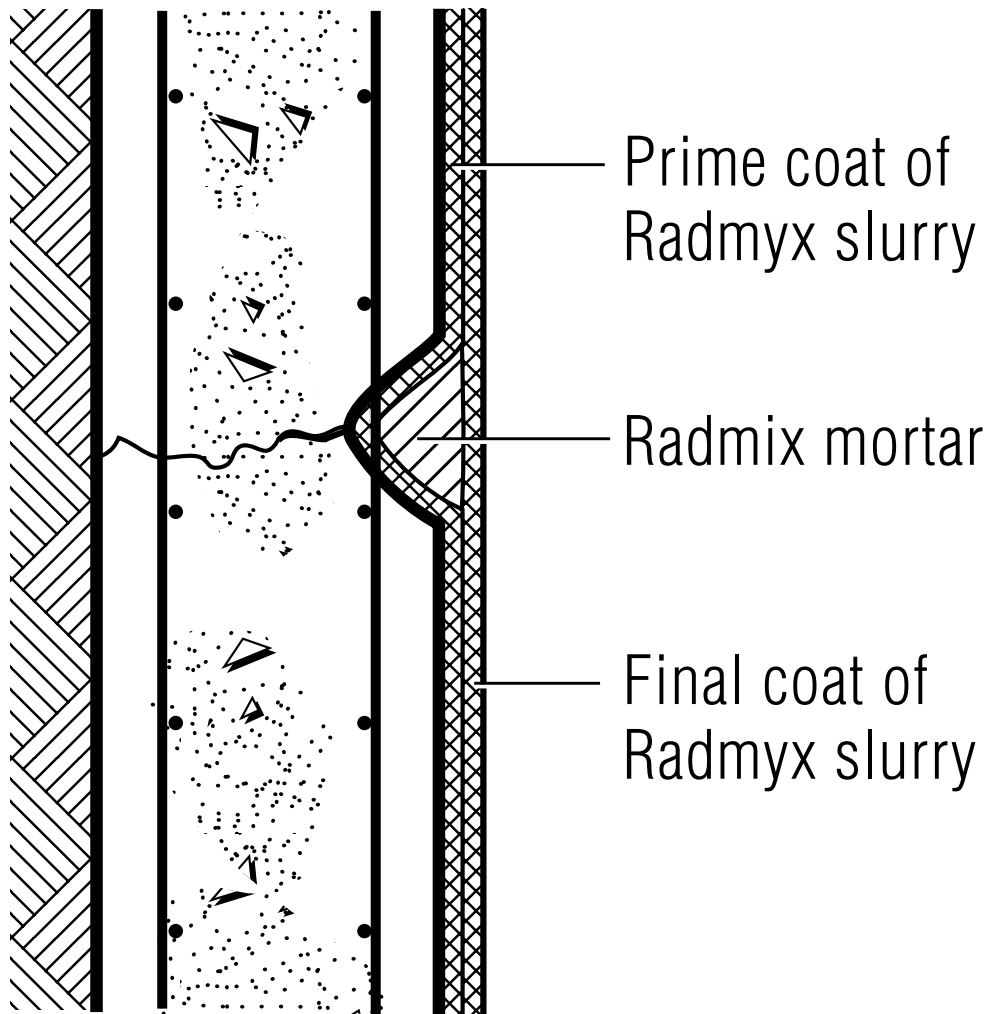

## CRACK/JOINT REPAIR

### Instructions:

- 1) Chase out to a depth of 30-40mm.
- 2) Dampen with water.
- 3) Prime area with Radmyx Slurry.
- 4) Laminate area with Radmyx Mortar in 30mm layers until the crack is filled.

## Honeycomb Repair

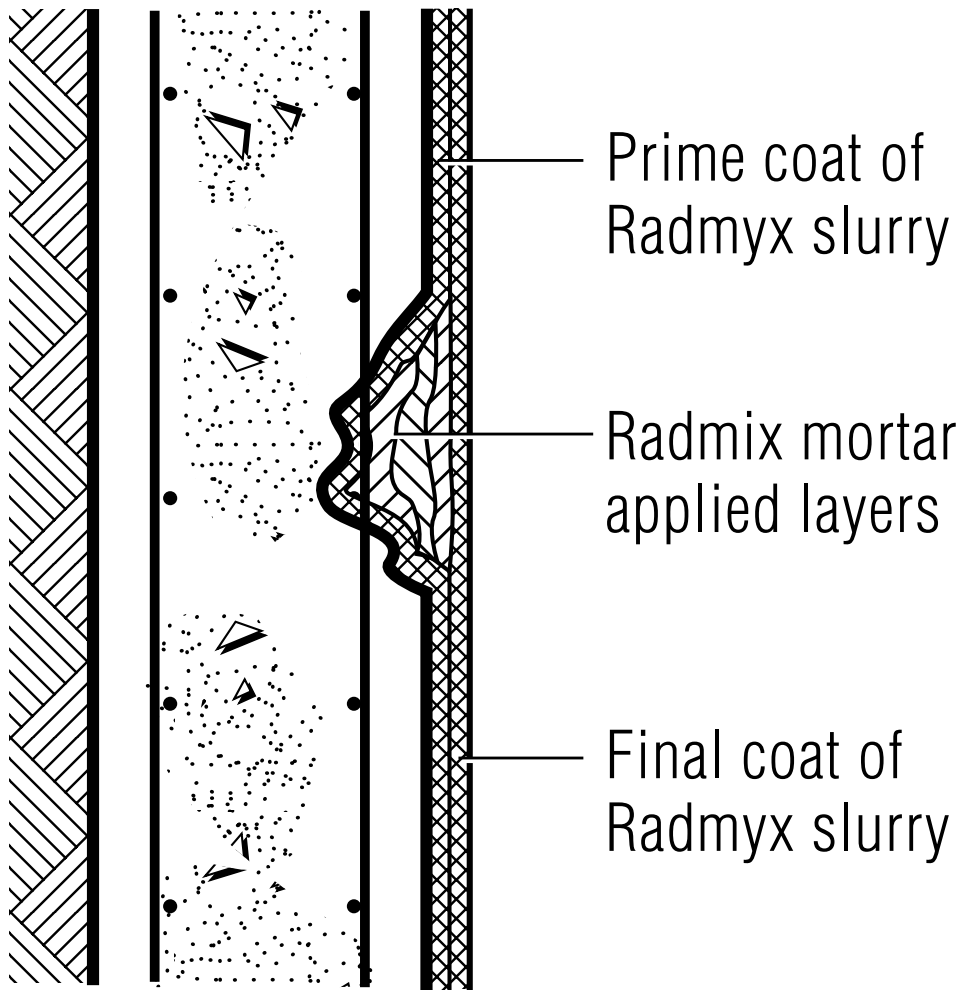

# HONEYCOMB REPAIR

### Instructions:

- 1) Hack out until solid concrete is found.
- 2) Dampen with water.
- 3) Prime area with Radmyx Slurry.
- 4) Laminate area with Radmyx Mortar in 30mm layers until the void is filled.